

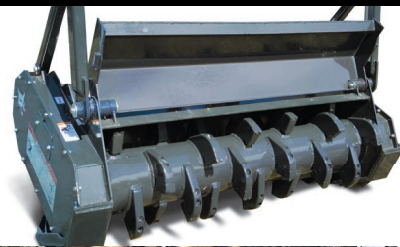

Bobcat®

Forestry Cutter Attachment Forestry Applications Kit

(Required to operate forestry cutter.
See back page for details)



One Tough Animal™

Forestry Cutter Attachment

- Smooth operation
- Fast production
- High visibility

Forestry Applications Kit

- Protection for the operator
- Protection for the machine



Looking for a complete? tree & brush management package ■

Bobcat Forestry Cutter Maintenance Training DVD



Provides operation and maintenance instructions.

This DVD is included with the Operation and Maintenance Manual.

Look to Bobcat!

Whether you're clearing every tree in an area or selectively thinning stands, choose the Bobcat® forestry cutter attachment. The compact size and legendary agility of Bobcat equipment lets you remove the trees you want—turning them into a bed of mulch that slows growth, and provides organic material for the trees you keep!

Cut higher trees and limbs down to size

Punch into large-diameter trees and bring the uppermost limbs quickly to the ground! The forestry cutter's tube-style drum and spiral tooth pattern allow one tooth to engage at a time—so operation is smooth and less horsepower is required to do the job.

Grind trees from top to bottom!

Why take a tree to the wood chipper when you can take a forestry cutter attachment to the tree? Simply lower the forestry cutter onto the tree and its fast-cutting teeth can rip it to shreds, or tear it to pieces by repeatedly hitting it from the side.

Produce mulch

Tilt the forestry cutter slightly forward to throw material against counter combs that reduce particles to mulch. Lowering the optional front gate will help retain material when finer mulching is necessary. If required, the forestry cutter has the ability to till the mulch right into the soil!

Forestry Cutter Features and Benefits



Tube Style Drum with Carbide Teeth

- Spiral tooth pattern allows one tooth to engage at a time for smoother operation and less horsepower demand
- Double-tipped carbide teeth efficiently rip through hard and soft woods, provide long life
- Low number of teeth (30) provides fast knockdown of trees and low-cost replacement
- Operate below grade to process mulch into the soil
- Pressure gauge is visible from the seat to help operator run the attachment at peak efficiency
- Standard adjustable push bar has three positions to accommodate operator's preferred setting
- Drum brake stops from full speed in 10 seconds or less when the forestry cutter's hydraulics are deactivated

The Bobcat Attachments Advantage: Bobcat attachments are engineered and manufactured to fit Bobcat loaders for optimum job performance, dependability and durability.



Mulching Counter Combs

- Counter combs provide the ability to do fine mulching and provide wear protection for the rear of the housing
- Safety chains reduce debris thrown to rear



Optional Front Gate

- Reduces front discharge of material
- Promotes longer processing into finer mulch
- Can be quickly added to any Bobcat forestry cutter

Specifications

Overall width 73.4 in.

Cutting width..... 60 in.

Operating weight..... 2329 lb.

Operating weight..... 2449 lb.
w/ front gate

Number of teeth 30

Tree diameter:

Continuous use 4-5 in.

Intermittent removal 7-9 in.

Occasional removal..... 10-12 in.

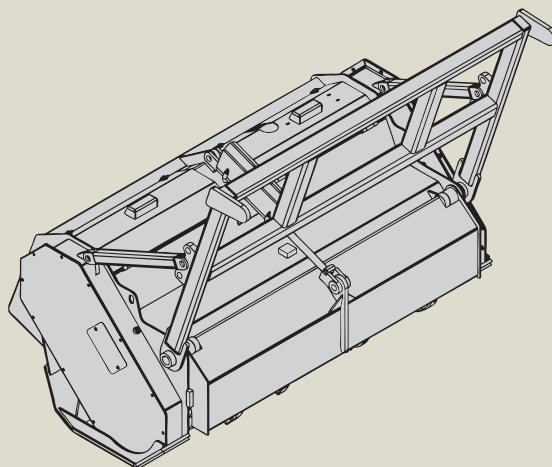

Bobcat® Forestry Cutter Attachment and Required Forestry Door and Applications Kit

Forestry Applications Kit: Protect Your Operator, Protect Your Machine



Designed to protect you, and your investment, in the toughest conditions, the forestry applications kit must be installed on the loader in order to operate the forestry cutter attachment. The exclusive forestry door protects you from flying debris and objects. Other benefits include ISO 3449 Level II Falling Object Protective Structure (FOPS) and debris guards for muffler, lights and hydraulic components.

The exclusive emergency exit allows removal of front door, if necessary.

NOTE - Where applicable, dimensions are in accordance with Society of Automotive Engineers (SAE) and ISO standards. Specifications and design are subject to change without notice. Pictures of Bobcat units may show other than standard equipment. All dimensions are given for loader equipped with standard tires. All dimensions are shown in inches. Respective metric dimensions are enclosed by parentheses. Bobcat Company complies with the requirements of ISO 9001 as registered with BSI.



The Forestry Applications Kit includes:

A Forestry Door (3/4 in. laminated polycarbonate)

The forestry cutter attachment will not operate without the door installed. Emergency exit allows removal of front door, if necessary

B Front and Rear Light Guards

1/4" polycarbonate material ensures branches and debris won't break lights

C Hydraulic Quick Coupler Guard

The guard, along with no exposed fittings on the hoses, helps protect the couplers, hoses and wire harness from falling trees and branches

D Fire Extinguisher

Mounted in the cab for quick access in an emergency

E Level II FOPS (meets ISO 3449)

Protects operator and cab from falling trees and objects

F Debris Screen for Radiator

Allows for longer operation time and easier cleanup of debris
(daily maintenance still required)

G Muffler Guard

Protects tailpipe from damage and reduces material buildup in the engine compartment

H Lift Cylinder Debris Shields

Protects lift cylinders, reduces material buildup in the engine compartment
(daily maintenance still required)

I Top and Rear Windows (1/4 in. polycarbonate)

Protects operator and maximizes visibility



Revendedor autorizado BOBCAT
Tel: (31) 3492-2772
Site: www.silmaquinas.com.br
E-mail: plinio@silmaquinas.com.br

Bobcat Company
P.O. Box 6000 • West Fargo, ND 58078
www.bobcat.com



Bobcat®

**Bobcat
Forestry
Cutter
Attachment
fits these
carrier
models*:**

**Skid-Steer
Loaders*:**
S300H
S330H

**Compact Track
Loaders*:**
T250H
T300H
T320H

**All-Wheel
Steer Loaders*:**
A300H

* Loader must
have proper
cooling
package.
See your
Bobcat dealer
for details.